

NOTES:

1. DO NOT SCALE OFF DRAWING, REFER TO LISTED DIMS ONLY!

2. ALL DIMS ARE FACE TO FACE OF SHEETROCK OR TO CENTERLINE OF DOORS AND WINDOWS UNLESS OTHERWISE NOTED. ANY DIMENSIONAL DISCREPANCIES SHALL BE BROUGHT TO THE IMMEDIATE ATTENTION OF THE EPOCH DESIGN DEPARTMENT FOR VERIFICATION.

3. ROOM AREA CALCULATIONS ARE APPROXIMATE.

4. CLOSET SHELVING BY FIELD CONTRACTOR.

EPOCH HOMES MANUFACTURES IT'S BUILDINGS TO CONFORM WITH THE FOLLOWING MASSACHUSETTS BUILDING CODES:

- 1. MA FUEL/GAS/PLUMBING CODES.
- 2. MA STATE BUILDING CODE, 6th EDITION.
- 3. 1993 BOCA NATIONAL MECHANICAL CODE W/ MA AMMENDMENTS.
- 4. 2005 NATIONAL ELECTRIC CODE W/ MA AMMENDMENTS.

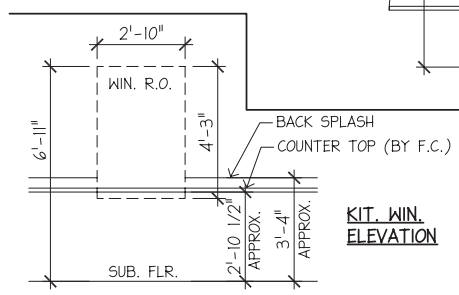

ROOM	SF	LIGHT	VENT
BEDROOM 1	134 SF	36	20
BEDROOM 2	100 SF	27	15
DINING/LIVING	219 SF	42	27
KITCHEN	107 SF	7*	4*
BATH 1	38 SF	0*	0*

* = MECHANICAL LIGHT/VENT.

NOTE:
EPOCH TO RAISE STD. WIN. HDR. HGT. TO MATCH EXT. DR. HDR. HGT.

NOTE:
NO CLOSET SHELVING BY EPOCH.

MANUF.	ID	TYPE	MATERIAL	SIZE	REMARKS	QTY
ANDERSEN	FWH60611	FRENCH	WOOD	6'-0" x 6'-8"	--	1

MANUF.	ID	TYPE	MATERIAL	RO WIDTH	RO HEIGHT	EGRESS*	REMARKS	QTY
ANDERSEN	A21	AWNING	WOOD/VINYL	2'-1"	2'-1"	NO	--	1
ANDERSEN	WDH28410	DOUBLE HUNG	WOOD/VINYL	2'-10"	5'-1"	YES	12/12	6
ANDERSEN	WDH2842	DOUBLE HUNG	WOOD/VINYL	2'-10"	4'-5"	YES	8/8	4

*EGRESS IN MA = MIN. 3.3 SF OPENING 20 X 24 IN EITHER DIRECTION

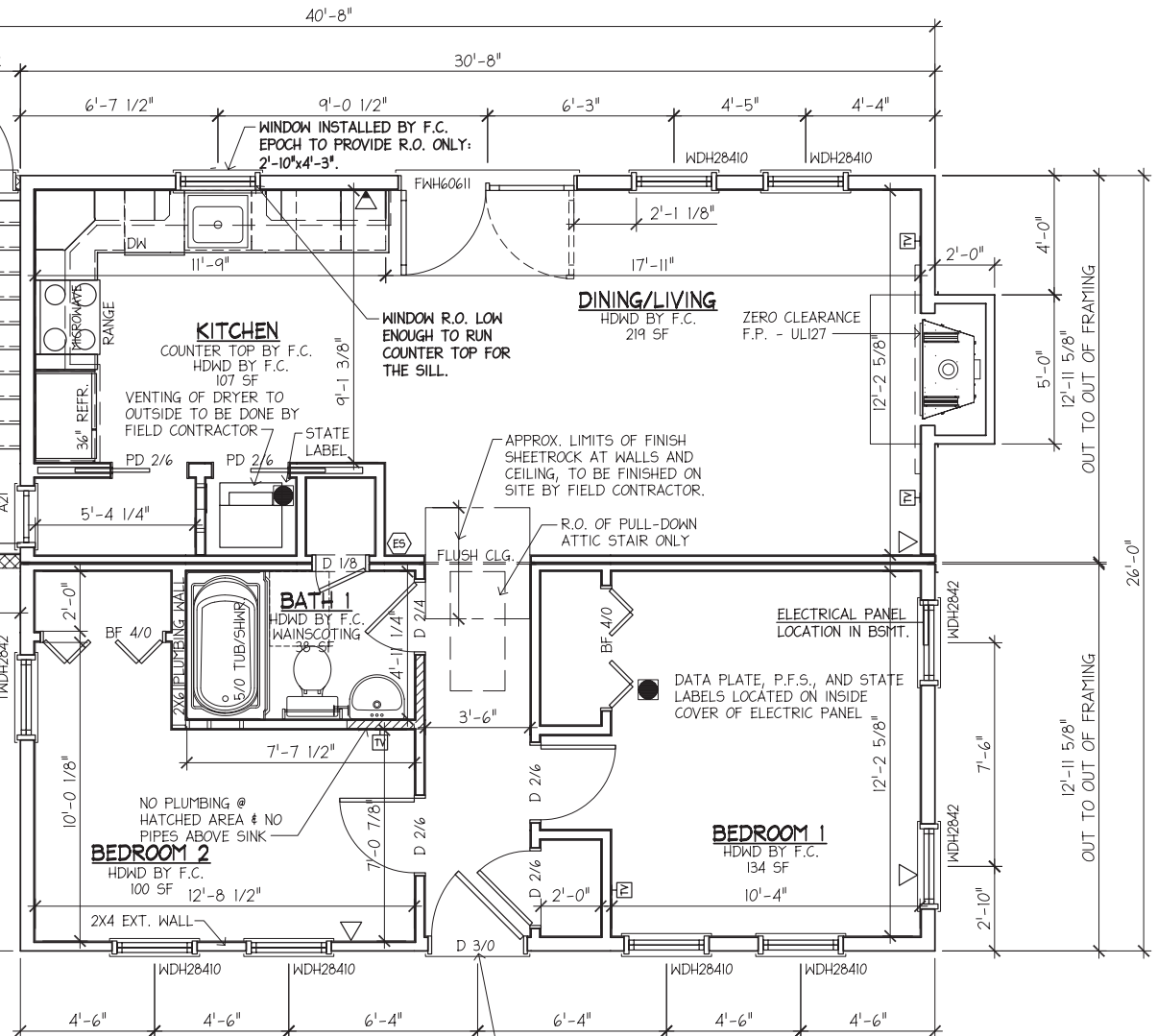

P-1 FIRST LEVEL FLOOR PLAN
SCALE: 1/4" = 1'-0"
CEILING HEIGHT = 8'-0"

EGRESS DOOR BY F.C. PER BUILDING CODE. EPOCH TO PROVIDE AN R.O. 3'-4"x6'-11".

NO.	DESCRIPTION	BY	DATE
1	PER PRFF DATED 1/17/06D	HN	2/1/06



ROUTE 106
P.O. BOX 235
PEMBROKE, N.H. 03275
(603) 225-3907
FAX: (603) 225-8329
www.epochhomes.com

PROJECT: CS086522 EXP. DATE: 11/26/07
26X31 CAPE
BUILDER:
S.E. DEVELOPMENT CO.
33 EAST AVENUE
MARION, MA 02738

NUMBER:
3880-05
ENDBUYER:
KNIPMEYER
MINK MEADOWS LOT 4
VINEYARD HAVEN, MA 02568

SHEET TITLE:
FIRST LEVEL FLOOR PLAN
DRAWN BY: JSA DATE: 12/28/05
SCALE: AS NOTED

SHEET NUMBER:
A-1